

**IOWA STATE
REC SERVICES**



SELF-GUIDED TOUR

BEYER
BEYER
BEYER HALL
BEYER
BEYER

BUILT IN 1960

SWIPE TO BEGIN



- + 75 FT LONG SWIMMING POOL
- + RACQUETBALL
- + SQUASH
- + BASKETBALL
- + VOLLEYBALL
- + FUNCTIONAL TRAINING ROOM
- + ESPORTS AND GAMING ROOM

BEVERLY HALL



TOUR ROUTE

FIRST FLOOR

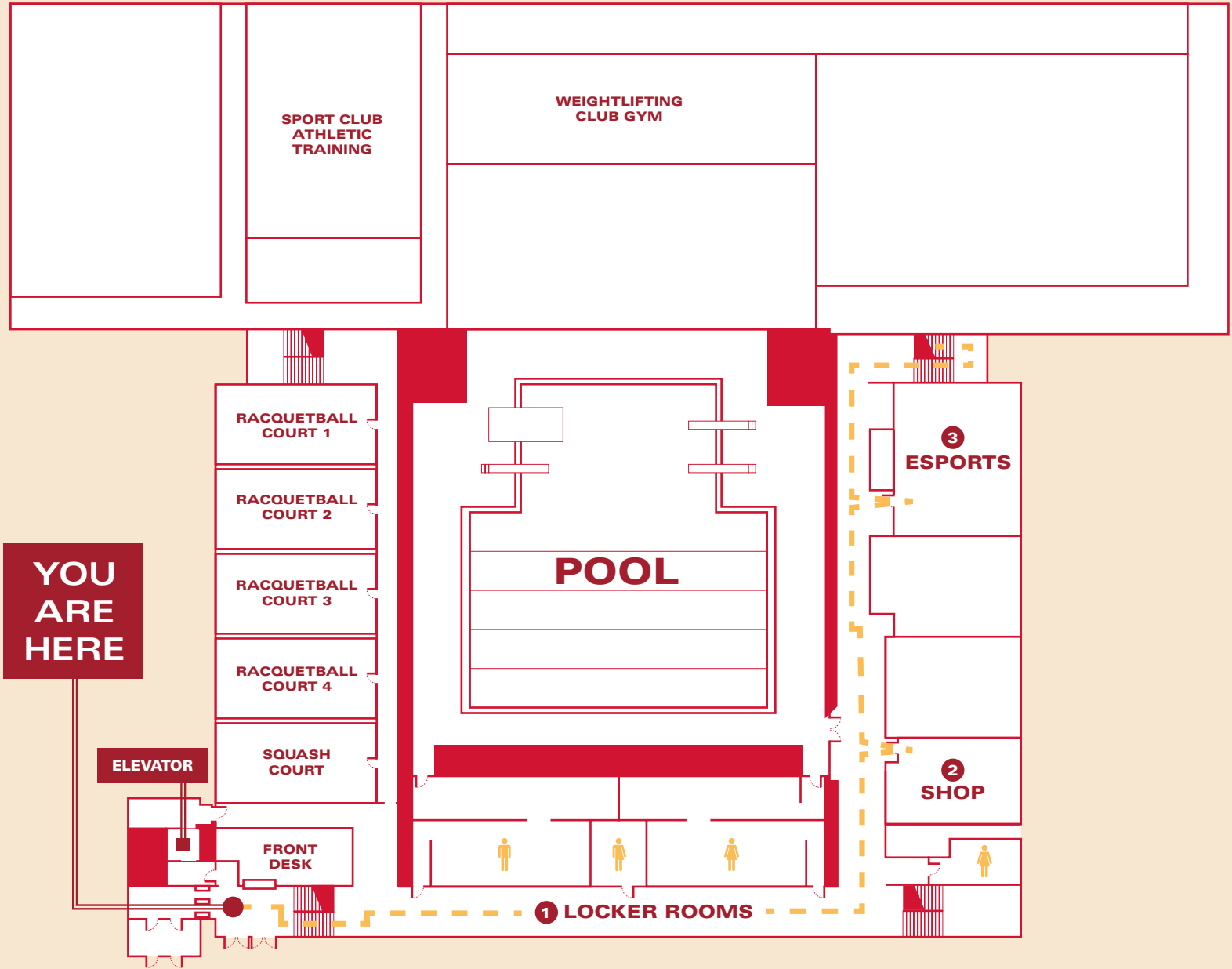

SECOND FLOOR

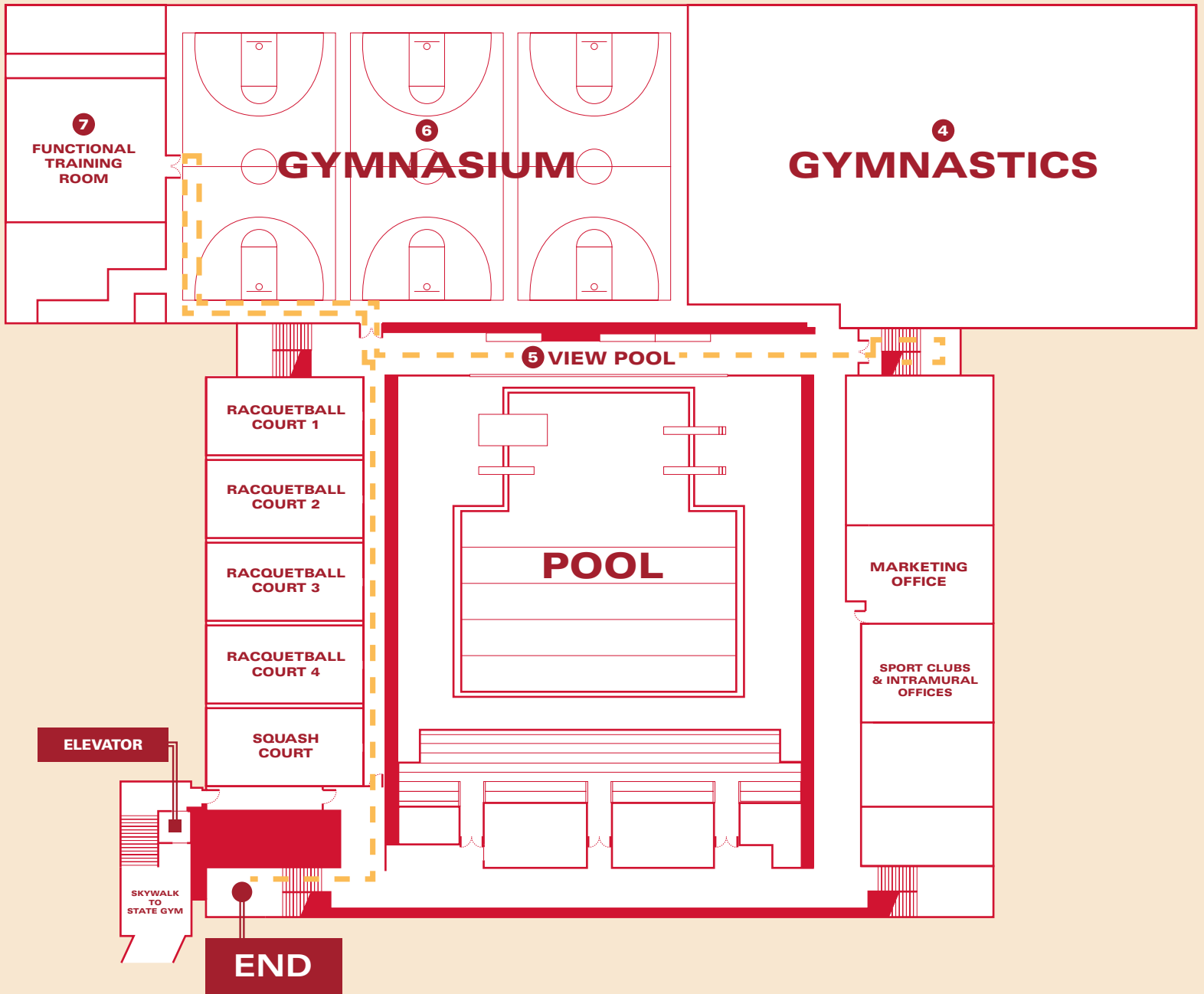

GO DOWN THE STAIRS ON THE RIGHT & CONTINUE DOWN THE HALLWAY



LOCKER ROOMS



On your left you will see a men's, women's, & unisex bathroom.



Iowa State University strives to create an inclusive and accepting community on and off campus.

Our locker rooms feature showers, hair dryers, and lockers that are available to rent to any members.

CONTINUE DOWN THE HALLWAY & TURN LEFT



SHOP FOOD PANTRY

**SHOP WILL BE THE SECOND
DOOR ON YOUR RIGHT**



***The SHOP, is a student-run,
on-campus food pantry at
Iowa State University.***

*Created in January 2011, a group
of students in the Food Science
and Human Nutrition (FSHN)
transfer learning community
were approached by ISU Dining
about the possibility of opening a
campus food pantry.*



“

OUR VISION IS TO ALLEVIATE FOOD INSECURITY WHILE COLLABORATING WITH IOWA STATE UNIVERSITY AND THE AMES COMMUNITY.

”

CONTINUE DOWN THE HALLWAY FOR THE ESPORTS ROOM



GAMING & ESPORTS ROOM



The Esports and Gaming Room features 30+ desktops and four console gaming stations.

The console gaming area is open for drop in and includes PS4, Xbox One, and Nintendo Switch. Gaming PCs are available for drop in use or can be reserved ahead of time.



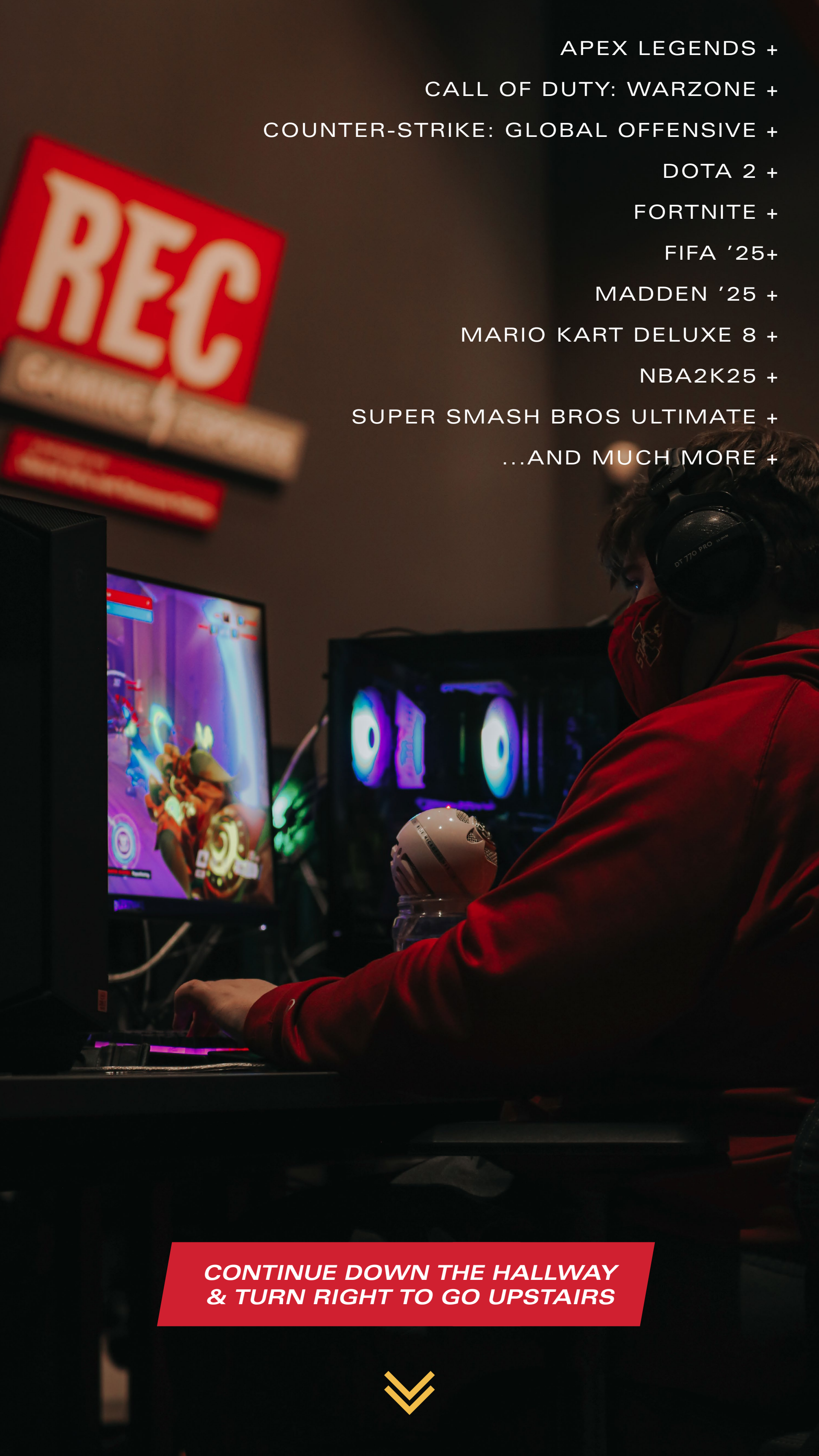

APEX LEGENDS +
CALL OF DUTY: WARZONE +
COUNTER-STRIKE: GLOBAL OFFENSIVE +
DOTA 2 +
FORTNITE +
FIFA '25+
MADDEN '25 +
MARIO KART DELUXE 8 +
NBA2K25 +
SUPER SMASH BROS ULTIMATE +
...AND MUCH MORE +

**CONTINUE DOWN THE HALLWAY
& TURN RIGHT TO GO UPSTAIRS**



GYMNASTICS

THE GYMNASTICS ROOM IS AT THE TOP OF THE STAIRS ON THE RIGHT



STATE
GYMNASTICS



From Around the World... We are CyclONES!



CONTINUE DOWN THE HALLWAY
TO VIEW THE POOL ON YOUR LEFT



LAP POOL & DIVE



The Beyer Pool features six 75 ft swim lanes, three diving boards, and a high dive.

Used by the Swimming Club, ISU's Swimming & Diving team, and any Recreation Services member. The Beyer Pool can be accessed through the locker rooms and is a great place to get some aerobic exercise.





CORDS

83	18
79	06
73	06
22	14
62	17
59	17
05	09
02	13
04	09
54	18
46	14
03	15
09	15
77	18
05	17
01	19
01	18
03	19
09	09
06	18
05	08
00	18

STATE
SWIMMING & DIVING

CONTINUE DOWN THE HALLWAY TO VIEW THE GYM ON YOUR RIGHT



GYMNASIUM

THE GYMNASIUM IS AT THE END
OF THE HALLWAY ON THE RIGHT



***The Gymnasium features
three basketball/volleyball
courts.***

*The Beyer Gym is used for
Intramural Sports such as
volleyball, basketball, indoor
soccer, and more. It is also
available for drop in use.*

ENTER THE GYM TO VIEW THE
FUNCTIONAL TRAINING ROOM





2

THE ENTRANCE TO THE FUNCTIONAL TRAINING ROOM IS ON THE FAR LEFT



FUNCTIONAL TRAINING ROOM



The Functional Training Room is used for Fitness Classes

Fun-filled classes like HIIT, Cross Training, TRX, Bootcamp, and more are held in the Functional Training Room. This room features free weights, rowers, kettlebells, a climbing rope, and more functional training equipment.



A man in a red t-shirt is performing a shoulder press in a gym. He is holding a barbell with a large black weight plate. The gym has a colorful mural in the background. The text "EXIT THE GYM AND GO STRAIGHT TO VIEW THE RACQUETBALL & SQUASH COURTS" is overlaid on a red banner at the top. There are yellow double chevron symbols at the top and bottom of the page.

**EXIT THE GYM AND GO STRAIGHT TO VIEW
THE RACQUETBALL & SQUASH COURTS**

SQUASH & RACQUETBALL COURTS

Beyer houses four racquetball courts and one squash court.

Equipment for racquetball and squash can be checked out from the front desk.

Beyer Hall's Squash court is one of the few in Iowa. In the entrance area there is signage on the history of squash, how to play, and different verbage used in the sport.

CONTINUE STRAIGHT THROUGH THE COURT VIEWING AREA





**TURN RIGHT AND GO DOWN THE STAIRS TO
RETURN TO THE FRONT OF THE BUILDING**

THIS CONCLUDES YOUR TOUR OF BEYER HALL

**FOR MORE INFORMATION
ON OUR OTHER FACILITIES
ON CAMPUS, SWIPE TO
CONTINUE!**



- + BASKETBALL COURTS
- + VOLLEYBALL COURTS
- + RACQUETBALL COURTS
- + INDOOR TURF FIELD
- + WEIGHTLIFTING EQ
- + CARDIO EQ
- + INDOOR TRACKS
- + BOXING STUDIO
- + FUNCTIONAL TRAINING EQ
- + BOULDERING WALL

LEED REC CENTER



- + BASKETBALL COURTS
- + VOLLEYBALL COURTS
- + BADMINTON COURTS
- + INDOOR TRACKS
- + MULTIPURPOSE ROOMS
- + WEIGHTLIFTING EQ
- + CARDIO EQ
- + LEISURE POOL
- + CYCLING STUDIO
- + FUNCTIONAL TRAINING EQ
- + BOULDERING WALL
- + TOP-ROPE WALL
- + OUTDOOR RECREATION PROGRAM

STATE GYM

